

# WILLIAM FRASER MEMORIAL PARK ON POHE ISLAND MASTERPLAN



## Document Control

**Name:** Catherine Hamilton



Auckland Office  
Level 3, The Westhaven, 100 Beaumont St  
PO Box 5848, Auckland 1141  
New Zealand

t: +64 9 355 9500

m: +64 27 615 6717

### Document Details:

**Date:** 21<sup>st</sup> August 2019

**Reference:** 1-13827.00

**Status:** **Final - V2**

### Prepared by:

Russell Cooper | Landscape Architect

Holly Stitt | Graduate Landscape Architect

### Reviewed by:

Catherine Hamilton | Principal Landscape Architect

# CONTENTS

<b>INTRODUCTION</b>	<b>01</b>
<b>VISION</b>	<b>02</b>
<b>SERVICE OUTCOMES</b>	<b>03</b>
<b>MASTERPLAN SUMMARY</b>	<b>04</b>
<b>LOCAL CONTEXT</b>	<b>07</b>
<b>SITE HISTORY</b>	<b>08</b>
<b>SITE FEATURES</b>	<b>09</b>
<b>KEY CONSIDERATIONS</b>	<b>11</b>
<b>CONCEPT DIAGRAM</b>	<b>13</b>
<b>GRAPHIC MASTERPLAN</b>	<b>14</b>
<b>MASTERPLAN DIAGRAMS</b>	<b>15</b>
<b>MARINE ZONE</b>	<b>19</b>
<b>HATEA HUB</b>	<b>23</b>
<b>BIKE HUB</b>	<b>26</b>
<b>KEY SITE MOVES</b>	<b>29</b>
<b>BENCHMARK PROJECTS</b>	<b>31</b>
<b>SITE MATERIALS PALETTE</b>	<b>32</b>
<b>SITE PLANTING MATERIALS</b>	<b>33</b>

# INTRODUCTION

THE MASTERPLAN FOR WILLIAM FRASER MEMORIAL PARK ON POHE ISLAND PROVIDES A BLUEPRINT FOR A THRILLING TRANSFORMATION FROM A CAPPED RUBBISH TIP TO A LIVING LANDSCAPE IN THE TRADITION OF THE WORLD'S GREAT PARKS. IT IS THE FIRST MAJOR MILESTONE IN IMAGINING AND PROJECTING A NEW FUTURE WHERE THE ISLAND WILL BECOME A PLACE OF ABUNDANT LIFE AND BEAUTY THAT THE COMMUNITY CHERISHES AND VISITORS DELIGHT IN.

LOCATED IN THE HEART OF WHANGAREI AND COVERING 54HA, THE PARK WILL BE A DIVERSE LANDSCAPE THAT CONTRIBUTES RICHLY TO THE SOCIAL, CULTURAL, ENVIRONMENTAL AND ECONOMIC WELLBEING OF THE PEOPLE AND PLACE. IT WILL DO THIS BY:

- Creating a strong identity for the park based on the history of its people and place
- Adopting a sustainability framework for the park to guide development
- Connecting the park thematically and physically to the wider city fabric
- Creating a layout that brings the park together into a cohesive whole
- Creating connections to and through the park for all ages and abilities
- Establishing diverse habitats and ecosystem services
- Managing water in a sustainable way
- Continuing to provide for a wide range of formal sports and active recreation facilities
- Providing a connected ribbon of informal recreation nodes which provide a range of activities and encourage longer stays and repeat visits
- Offering a wide range of events and curated experiences
- Providing education and advocacy based around sustainability
- Creating coherent, attractive design standards for all infrastructure
- Providing opportunities for public art and sculpture



ECOLOGICAL ENHANCEMENT



CULTURAL IDENTITY



FORMAL SPORTS



CONNECTION TO URBAN HUB



INFORMAL RECREATION



COMMUNITY EVENTS

# GALVANISING IDEA

William Fraser Memorial Park on Pohe Island | The Great Park of Whangarei

# VISION STATEMENT

TO REHABILITATE AND RECYCLE A PIVOTAL PIECE OF CENTRAL WHANGAREI LAND TO BECOME A LIVING LANDSCAPE IN THE TRADITION OF THE WORLD'S GREAT PARKS, AND A HIGHLY TREASURED HEART OF THE COMMUNITY.



# SERVICE OUTCOMES

A SET OF SERVICE OUTCOMES FOR POHE ISLAND HAVE BEEN ESTABLISHED TO HELP GUIDE THE DEVELOPMENT OF THE MASTERPLAN.

THESE OUTCOMES PROVIDE A FRAMEWORK TO ENSURE THE PARK IS DEVELOPED TO ITS FULL POTENTIAL IN TERMS OF THE SOCIAL, CULTURAL, ENVIRONMENTAL AND ECONOMIC WELLBEINGS.



## ECOLOGY

- Wildlink connections
- Habitat restoration
- Constructed nature
- Riparian enhancement
- Water quality



## EXPERIENCE

- Blue/Green backdrop
- Visual quality and cohesion
- Protection from elements
- Vistas to significant landscapes
- Biophilic connections



## ENVIRONMENTAL MANAGEMENT

- Water management
- Landfill management
- Resilience
- Climate Change



## CONNECTIONS AND ACCESS

- Active street edge
- Diverse pathway network
- Rationalised entry / egress points
- Logical vehicle access and parking
- Alternative transport options
- Integrated connections



## PLACEMAKING

- Community identity
- Regional destination
- Site Activation
- Sense of Place
- Tourist Destination



## ACTIVE RECREATION

- Field lighting
- Toilet and change facilities
- Multi-activity sportsfields
- Spectator provisions

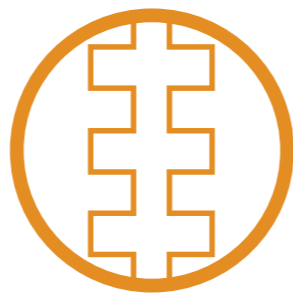

## ARTS, CULTURE, HERITAGE

- Community events
- Art installations
- Temporary activation
- Regional narratives
- Cultural landmarks



## PASSIVE RECREATION

- Dog walking / training
- Youth activity zone
- Picnic and leisure
- Play trails, nature discovery
- Walking, cycle and fitness trails
- Multi-generational

# MASTERPLAN SUMMARY

WILLIAM FRASER MEMORIAL PARK ON POHE ISLAND IS ABOUT TO UNDERGO A TRANSFORMATION FROM A CLOSED LANDFILL SITE TO A LIVING LANDSCAPE. ONCE COMPLETE, THE PARK WILL BECOME A PLACE OF LIFE AND VITALITY - A CHERISHED HEART OF THE WHANGAREI COMMUNITY. AT 54HA IT WILL BECOME THE GREAT URBAN PARK OF WHANGAREI.

THE TRANSFORMATION OF WILLIAM FRASER MEMORIAL PARK IS A PROGRESSIVE ENTERPRISE. ORIGINALLY A 1HA ISLAND LOCATED ON THE MUD FLATS OF THE WHANGAREI INNER HARBOUR, THE ISLAND HAS BEEN FILLED OVER THE YEARS SO THAT TODAY IT IS A CLOSED AND CAPPED LANDFILL SITE DEDICATED TO RECREATION USE AND ENJOYMENT.

DUE TO ITS NATURE AS A CAPPED LANDFILL, DEVELOPMENT OF THE SITE HAS OCCURRED IN AN OPPORTUNISTIC WAY WITH SUITABLE AREAS BEING PROGRESSIVELY DEVELOPED. WHILE THIS HAS PROVIDED A PRACTICAL APPROACH TO RECREATION PROVISION, IT IS NOW TIME TO CREATE A BLUEPRINT THAT IMAGINES THE PARK IN A COHESIVE WAY. THIS MASTERPLAN IS THAT BLUEPRINT.

THE MASTERPLAN CREATES AN OVERALL SPATIAL ARRANGEMENT TIED THROUGH A NETWORK OF PATHWAY CONNECTIONS AND TRACTS OF CONTIGUOUS VEGETATION. WITHIN THIS SPATIAL PLAN ARE A SERIES OF SUB-SPACES, EACH DEDICATED TO DIFFERENT ACTIVITIES AND POSSESSING DISTINCTIVE LANDSCAPE CHARACTER.



MARINE ZONE

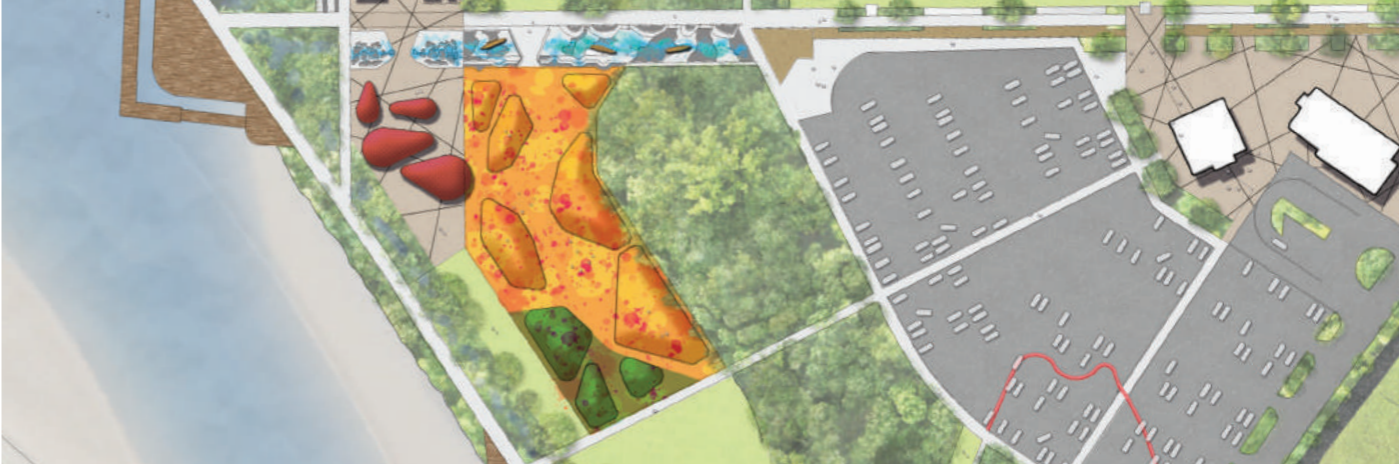

HATEA HUB



BIKE HUB WITH COMMUNITY FACILITIES

# MASTERPLAN SUMMARY

## KEY FEATURES OF THE MASTERPLAN ARE:

**Re-nature** – a programme of ecosystem creation is established across the site. Habitat areas include salt marsh, wetland, woody forest and emergent tree stands.

**Connectivity** – a network of paths and trails around the site connect the various areas of the park and provide for people of all ages and abilities to move with ease around the site.

**Spine path** – a grand avenue is established along the east-west axis, connecting the path from edge to edge. At the eastern end of the will be an elevated lookout which provides visual connections to the harbour and horizon. At the Western end of the spine path will be a corresponding lookout that showcases views across the Hatea River to the Waka and Wave sculpture on the opposite shore.

**New Bridge** – A feature of the spine path is a new bridge that rises up and over the road at the eastern end of the park, giving pedestrians priority and creating a means of activating the eastern edge of the park.

The spine path is a key spatial device to connect and distribute park visitors around the site via a series of transitions and nodes. These include:

**Marine Hub** – the focus of the Marine Hub is to continue to bring together water related activities into a concentrated hub, in a way that allows both marine hub users and members of the public to interact and enjoy land/water activities. A key new feature of this area is the pontoon and observation deck which will allow closer interaction with the river.

**Hatea Hub** – a place of informal recreation activities focused around play, picnicking, youth activities and informal events. This area will become a key family gathering space.

**Gateway Hub** – strategically located at the intersection of the main road entrance and spine path, this is a place for visitors to meet up and distribute to the various destinations around the site.

**Bike Hub** – building on the existing focus of this area for cycling related activities, the bike hub will offer a diverse range of biking experiences centred around a multi-purpose community gathering space.

## OTHER KEY FEATURES OF THE SPACE

**Rally route** – will be retained and re-aligned to allow for the optimisation of this significant annual event to co-exist with the newly programmed spaces and activities on the reserve.

**The Hatea Loop walkway** – will connect into a wider network of paths, roads and tracks that collectively for the connecting tissue of the park.

**Birthmark** – marking the location of the original island, this spot recalls the pre-developed condition of the land/water through a symbolic gesture featuring art, sculpture and manuka planting.

**Event space** – the location of the circus will continue to be a major event space with surrounding amenities and facilities including vendor areas, toilets, shelter and seating.

**Central green** – this area will remain an open grassed area as settlement of the capped fill site is expected to take many years. Viewing locations are provided for the rally and other events on the lower ground as well as to provide opportunities to see out the surrounding city and seascapes.

**Dog park** – the dog park will be developed to provide expanded facilities related to dog care and activity – such as grooming and dog café.

**Riverside** – a walkway with stopping and viewing points along the way will weave along the edge of the reserve between swathes of coastal edge planting.

**Rugby club buildings** – a series of three multi-use buildings will be established along the edge of the sports fields.

**Connection** – a strong connection onwards to Parihaka Reserve walking tracks.





Illustrative Masterplan of William Fraser Memorial Park on Pohe Island

# WHANGAREI CONTEXT

POHE ISLAND COMPRISES 54HA OF RIVERSIDE LAND IN CLOSE PROXIMITY TO THE WHANGAREI CITY CENTRE AND TOWN BASIN. IT IS A CRITICAL POSITION IN THE HATEA LOOP WALKWAY AND THE LANDING POINT OF ICONIC BRIDGE TE MATAU Ā POHE.

THIS SUBSTANTIAL PORTION OF CENTRAL CITY LAND IS A SIGNIFICANT CONTRIBUTION TO WHANGAREI'S PUBLIC OPEN SPACE NETWORK, PROVIDING BOTH FORMAL AND INFORMAL RECREATION OPPORTUNITIES TO THE WIDER WHANGAREI DISTRICT.

## KEY

- Site Extent
- Hātea Loop Walkway
- ⋯ Railway
- State Highway 1
- City Centre
- Residential
- Parks & Reserves
- Commercial
- Industrial
- Schools/Education
- Parks
- Countryside
- Town Basin

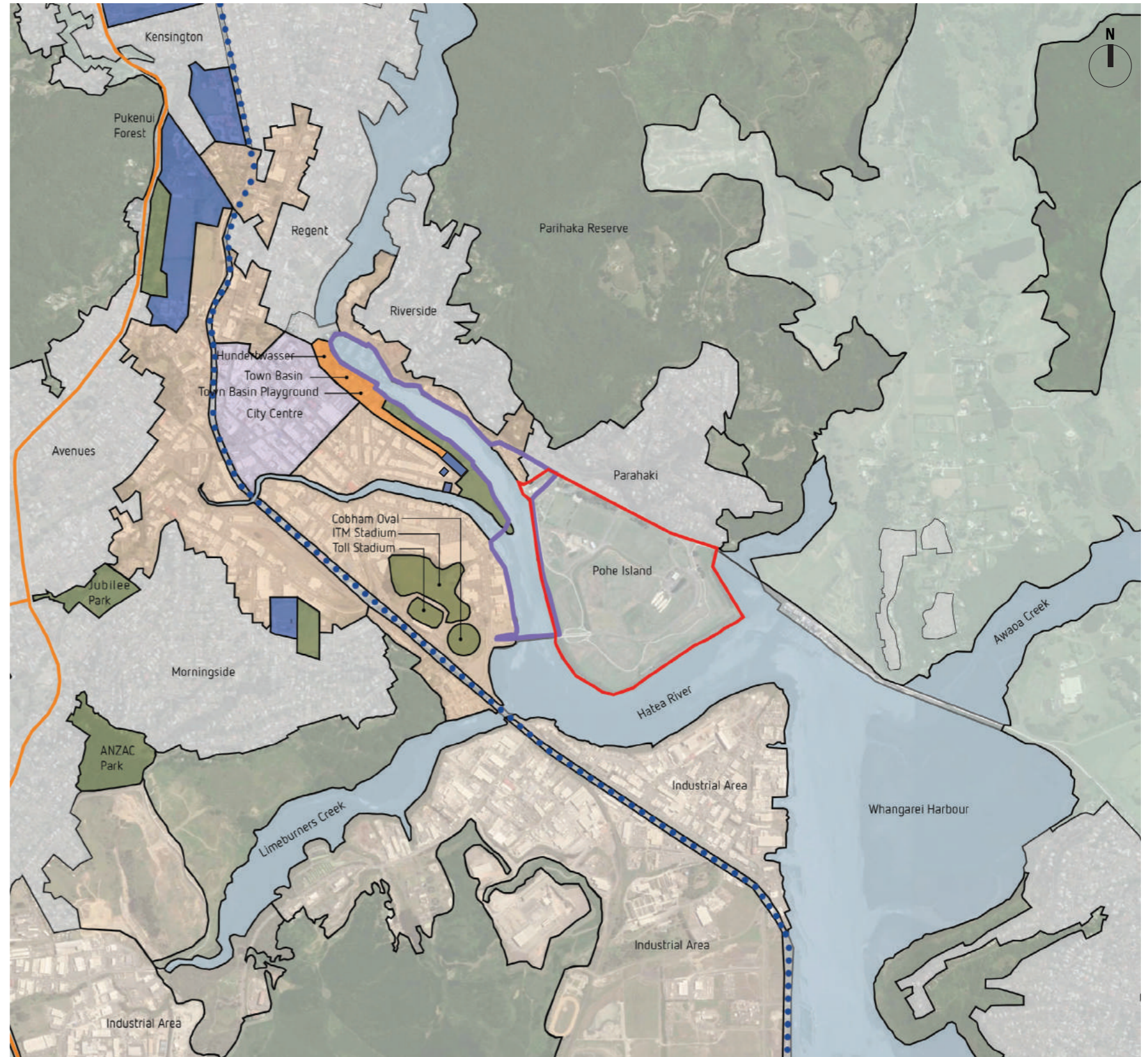

1:5000 @ A1  
1:10000 @ A3

# HISTORY OF RECLAMATION AND LAND USE

POHE ISLAND HAS BEEN HIGHLY MODIFIED THROUGH A VARIETY OF PROCESSES OVER TIME. AN ORIGINAL SKETCH PLAN PRODUCED BY THE MĀORI LAND COURT IN 1907 SHOWS THE ORIGINAL MANUKA SCRUB COVERED 'POHE'S ISLAND' MEASURING LITTLE OVER 0.5HA, SURROUNDED BY MUDFLATS AND RINGED BY MANGROVES AT THE COASTAL RIVERS EDGE.

FOLLOWING RECLAMATION OF THE SURROUNDING MUDFLATS BY USE OF STOP BANKS, DRAINS AND RIVER DREDGING'S THE SITE WAS USED FOR AGRICULTURAL ACTIVITIES.

FOLLOWING THIS THE NEXT NOTABLE ACTIVITY WAS THE SITES USE FOR REFUSE DISPOSAL, ESTABLISHING THE CURRENT CONCERNS FOR REHABILITATION OF LANDFILL SITES – GROUND STABILITY, GAS EMISSIONS AND CLAY CAPPING.

FOLLOWING THE RETIREMENT OF THE LANDFILL USE, THE SITE SHIFTED FOCUS TO RECREATION USES WITH THE DEVELOPMENT OF SPORTS FIELDS.

THE SITE NOW IS USED FOR THE FOLLOWING RECREATION ACTIVITIES: SKATE, BMX, ROWING, SCOUTS, MARINERS, FOOTBALL, ROCK 'N' ROLL, RUGBY, DOG EXERCISE, RALLY OF NEW ZEALAND AND PASSIVE RECREATION



# EXISTING SITE



## KEY

- Hātea Loop
- Onerahi Cycleway
- Pohe Island Cycleway
- Rally Track
- === Sea Wall Bunding
- Residential
- Parks & Reserves
- Foreshore Edge

1:2500 @ A1  
1:5000 @ A3  
0 40 80 120 160 200 240 m

# EXISTING SITE FEATURES



A. HATEA CYCLEWAY AND GRASS BANKS



B. LARGE DOG PARK AND CAR PARK



C. LAND DRAIN AND BUNDING



D. TE MATAU Ā POHE BRIDGE



E. DECOMMISSIONED REFUSE CENTRE



F. WAKA AND WAVE SCULPTURE AT HIHIAUA PARK



G. MARINE ACTIVITY BUILDINGS



H. CAR PARKING NEXT TO FOOTBALL FIELDS



I. SKATE PARK AND ASSOCIATED CAR PARKING

# LANDFILL

Pohe Island presents a series of challenges stemming from the historic landfill. Discreet projects identified within the master planning process will individually need to assess the risks and establish responses to mitigate these challenges. Well-formed design responses have the potential to sit on this landscape to create an integrated series of outcomes with the ability to mitigate and manage these risks, but also going further to improve the environmental quality of Pohe Island and its surroundings.

Maintaining a healthy environment for user groups is imperative to the success of any future works and projects around the world are demonstrating that the reuse of landfill sites can provide quality recreation environments whilst managing landfill process.

Key to enabling future works will be a strong understanding of cap integrity and gas management, with the general conclusion drawn that some portions of landfill cap will need remediation during pre-loading phases of works, but also the key realisation that a major portion of landfill and cap will undergo settlement and change that will be prohibitive to any works until this process reaches the end of degeneration, with a projected 30-50 year stand-down of this area.

The general intent of all proposed works within the masterplan is the need for all works to sit atop existing levels. Stormwater will be managed above the existing surface through perched wetlands for water detention and treatment prior to discharge, bunding and soil addition for plant establishment and vegetated swales and rain gardens to manage surface run off. Structures will need specific design to ensure no penetrations to landfill capping, making use of gravity mass foundations and fill to increase levels for concealment. Recognising these challenges is not prohibitive to future works, but does add additional challenges as design develops.



■ Extent of clay cap  
● Indicative Methane Hotspots

# HYDROLOGY

Future proofing new infrastructure against sea level rise and extreme weather events will be pivotal to success of outcomes.

As all water will need to be managed as surface run off with discharge to the Hatea river there is opportunity to establish standards for improvement of water quality reaching the Hatea, through the use of vegetated swales, raingardens and wetlands for treatment and settlement of contaminants prior to discharge.

Due to reclamation of the landmass there is significant risk of sea level rise, building in redundancies in swales and riparian edges and defining a position of retreat to ensure investment in infrastructure is futureproofed.

Minimising effects of erosion and sedimentation by slowing surface run off and detaining where possible through the use of vegetation and wetlands.

Recognising the aesthetic and amenity benefits of integrated sustainable stormwater management and the community education and involvement potential.

Recognising the ecological and habitat opportunities available in sustainable stormwater management.

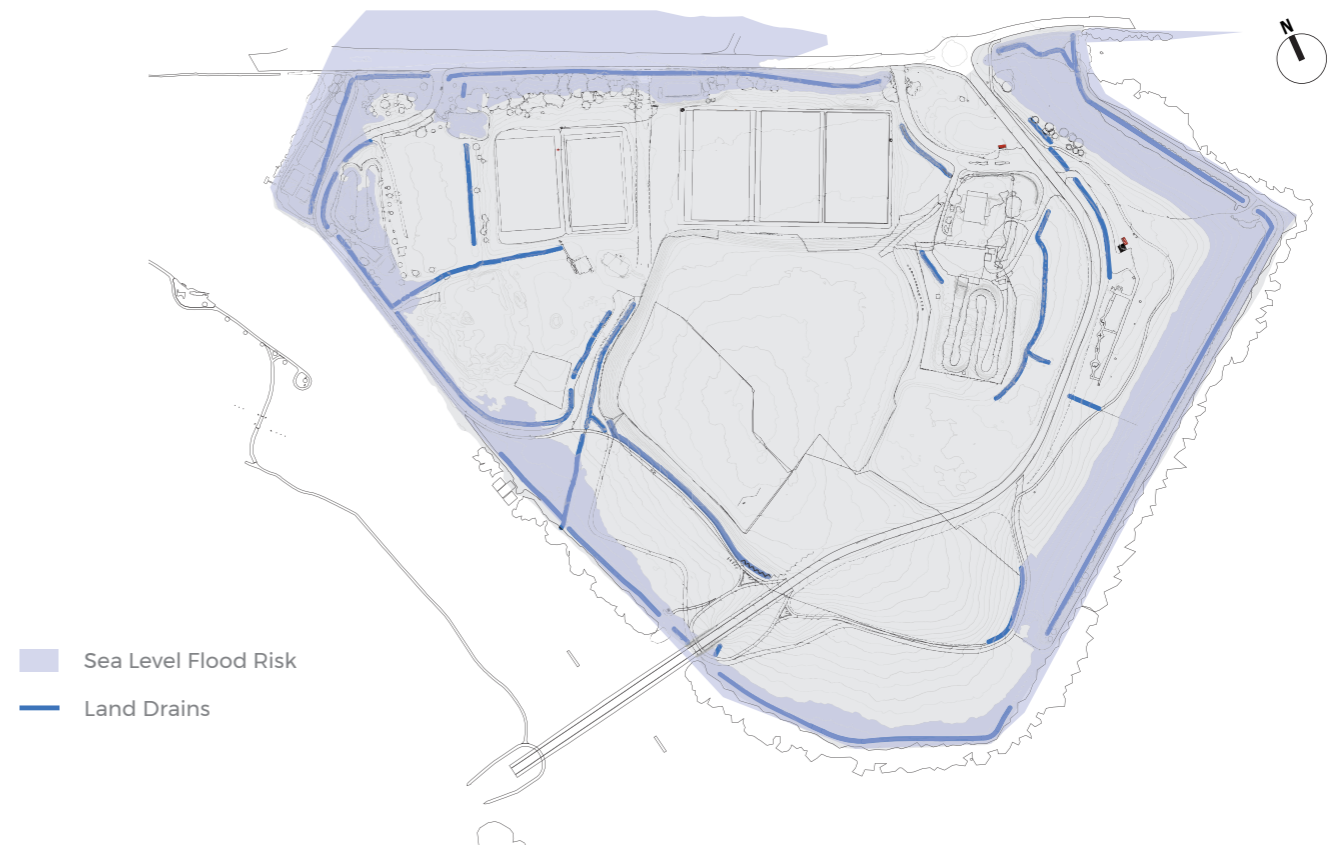

■ Sea Level Flood Risk  
— Land Drains

# CURRENT SITE PROGRAMME

Future site development will be staged to correspond with the settlement and stabilisation of ground conditions. Activities in addition to the existing illustrated are programmed as follows:

- Sports fields and associated active recreation in the northern part
- Bike activities in the north eastern part
- Informal recreation through the eastern and south eastern part
- Rally event through the southern part
- Riverside walk and informal recreation through the western part
- Family gathering, events, play, youth zone and marine activities in the north and north west part
- Informal grassed area in the centre of the site
- Connections through multi-modal non-motorised movement throughout the site.

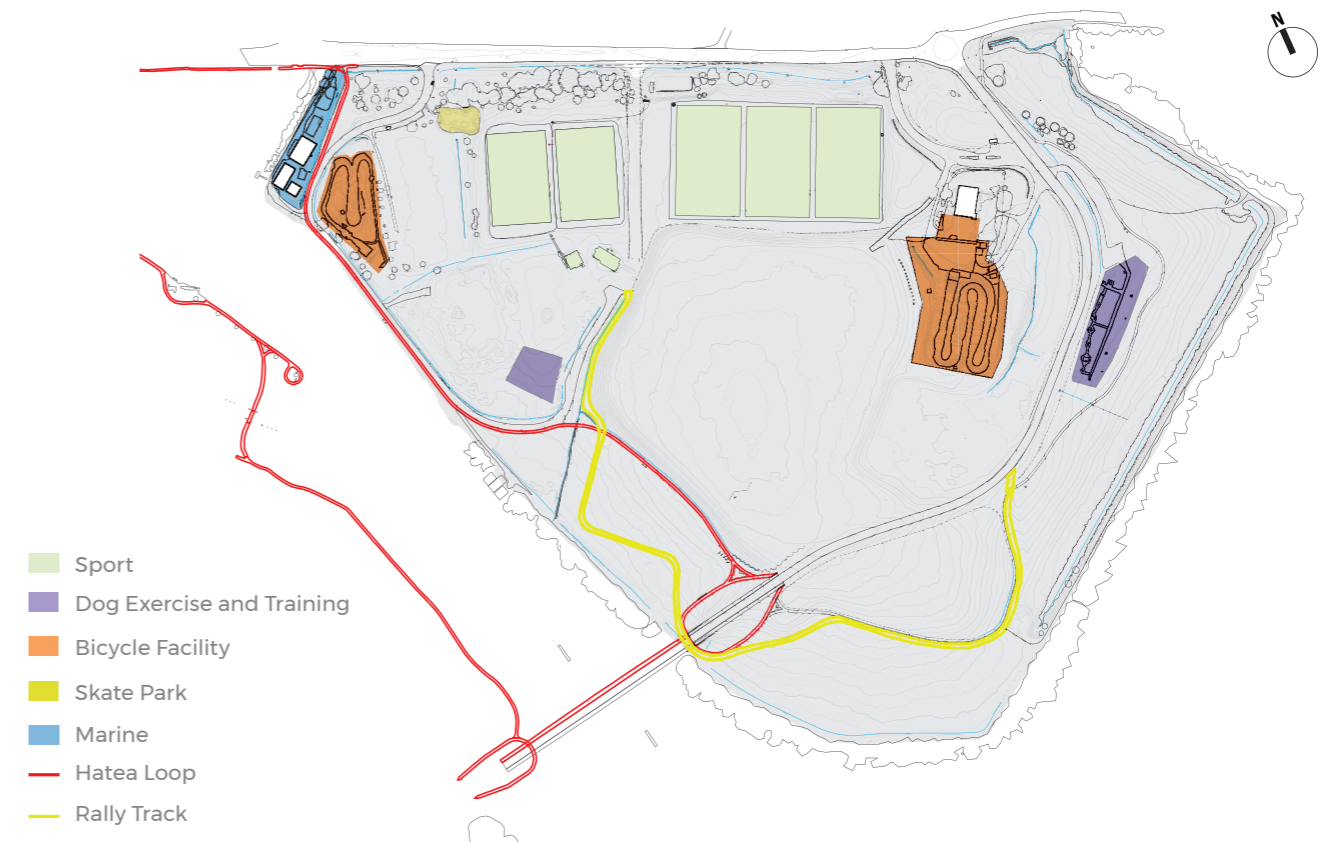

# CLIMATE

Prevailing wind is from the south west while the localised hillside topography to the north provides shelter.

The full site has good sun penetration, with the spine path and hubs along the route enjoying particularly favourable sunny aspects.

Overall, the climate change predictions are such that infrastructure will need to be generally kept back from the edge and lifted to allow for sea level rise and to prevent damage from increasing storm surges.

Opportunities to harness clean energy including wind and solar should be considered for all new infrastructure.

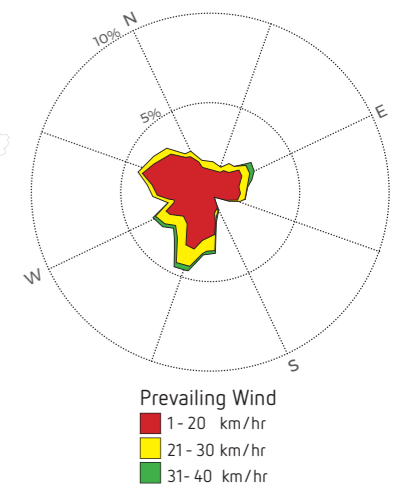
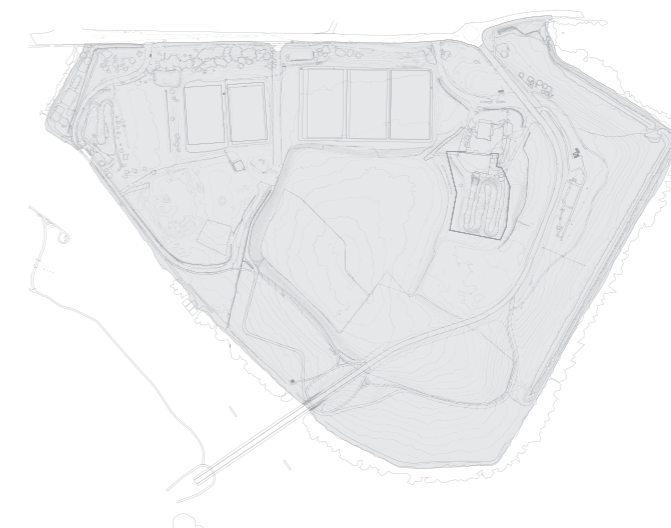
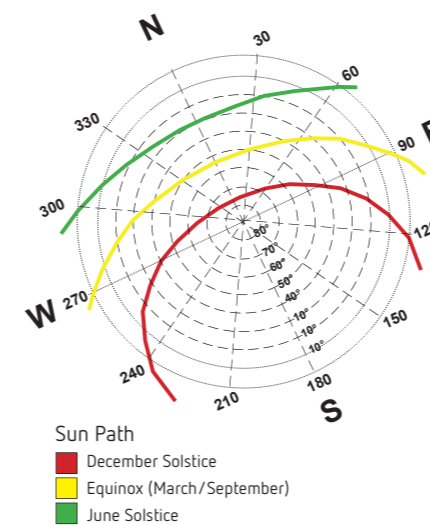

# CONCEPT DIAGRAM - SPATIAL AND EXEMPLAR IMAGES



**A** HATEA HUB  
events, play, nature,



**B** GATEWAY HUB  
meet, orientate, distribute



**C** BIKE HUB  
social, vibrant, bike, pop  
ups, markets



**D** HARBOURSIDE MARKER  
sculpture, lookout



**E** MARINE ZONE  
purpose built, floating  
platforms, launching

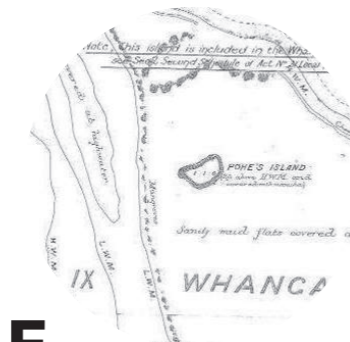

**F** POHE BIRTHMARK  
representation of  
original island



**G** RIVER'S EDGE  
riparian planting, rest areas,  
connection with water



**H** VIEWING PLATFORMS  
elevation, lookout,  
observation



**I** YOUTH PARK WITH SKATE  
integrated, diverse





# MASTERPLAN



# ACTIVITY AND PROGRAMME



# BUILDINGS AND INFRASTRUCTURE



# CIRCULATION



**LEGEND**

- Car parking
- Public Vehicle Access
- Vehicle Service Access Only
- Vehicle Service/Public Event Access
- Spinal path avenue
- Shared Pathway Network

Whole site available for emergency and service vehicles

# LANDSCAPE AND ECOLOGY



**LEGEND**

- Wetland or Vegetated Swale
- Native Revegetation
- Grassland / Meadowland
- Amenity Lawns
- Riparian Edge / Transitional Saltmarsh
- Feature Manuka Recalling Condition of Original Pohe Island Footprint

# MARINE ZONE - 5-10 YEAR PLAN

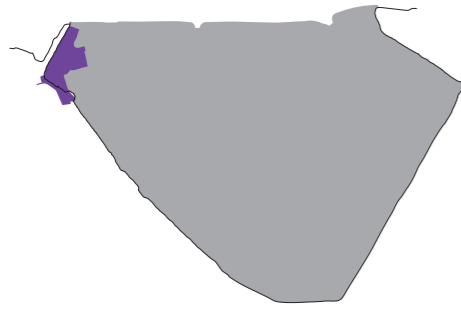

## Legend

- 1 Proposed Pedestrian and Cycle Bridge
- 2 Proposed realignment of Hatea Loop
- 3 Pedestrian Crossing
- 4 Parking and Parade Grounds
- 5 Existing Young Mariners Building
- 6 Existing Rowing Club Building
- 7 Existing Cadets Building
- 8 Proposed Relocated Scouts Building
- 9 All tides access floating pontoons for Marine Clubs
- 10 Gangway to pontoons
- 11 Upgraded boat ramp
- 12 Observation Deck overlooking Hatea River and Pontoons with potential use as events stage with outlook back to terraced bank
- 13 Existing pump track
- 14 Proposed Toilet and change facilities
- 15 Proposed Community Pavillion / Concessions
- 16 Proposed Community hub - Shelters, Barbeques, Group Dining Tables and Seating
- 17 Proposed Amenity Wetland and Stormwater Detention prior to discharge to Hatea River
- 18 Events Lawn
- 19 Waka and Wave Sculpture
- 20 Gathering/pause point with sculpture, seating and interpretation
- 21 Existing access road and turning head
- 22 Proposed Playground
- 23 Site Spine
- 24 Waterplay



1:1000 (A3) 0 5 10 15 20 25 30 35 40 45 50 m

# MARINE ZONE - 10+ YEAR PLAN

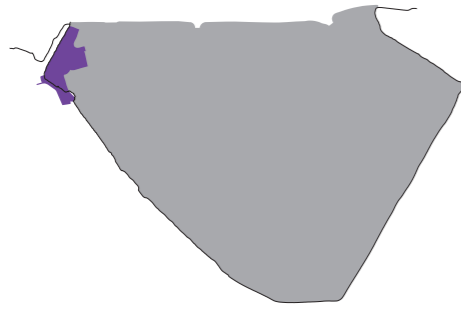

## Legend

- 1 Proposed Pedestrian and Cycle Bridge
- 2 Proposed realignment of Hatea Loop
- 3 Shared space Hatea Loop and pedestrian crossing
- 4 Carpark expansion
- 5 Marine Clubs upgraded building zone
- 6 Marine Club dedicated hard stand
- 7 All tides access floating pontoons for Marine Clubs
- 8 Gangway to pontoons
- 9 Extended all tides pontoons for public access and water connection
- 10 Upgraded boat ramp
- 11 Vehicle manouvering and loading zone
- 12 Observation Deck overlooking Hatea River and Pontoons with potential use as events stage with outlook back to terraced bank
- 13 Proposed Toilet and change facilities
- 14 Proposed Community Pavillion / Concessions
- 15 Proposed Community hub - Shelters, Barbeques, Group Dining Tables and Seating
- 16 Proposed Amenity Wetland and Stormwater Detention prior to discharge to Hatea River
- 17 Proposed terrace seating
- 18 Events Lawn
- 19 Waka and Wave Sculpture
- 20 Proposed reserve space
- 21 Extended access road
- 22 Proposed Playground



1:1000 (A3) 0 5 10 15 20 25 30 35 40 45 50 m

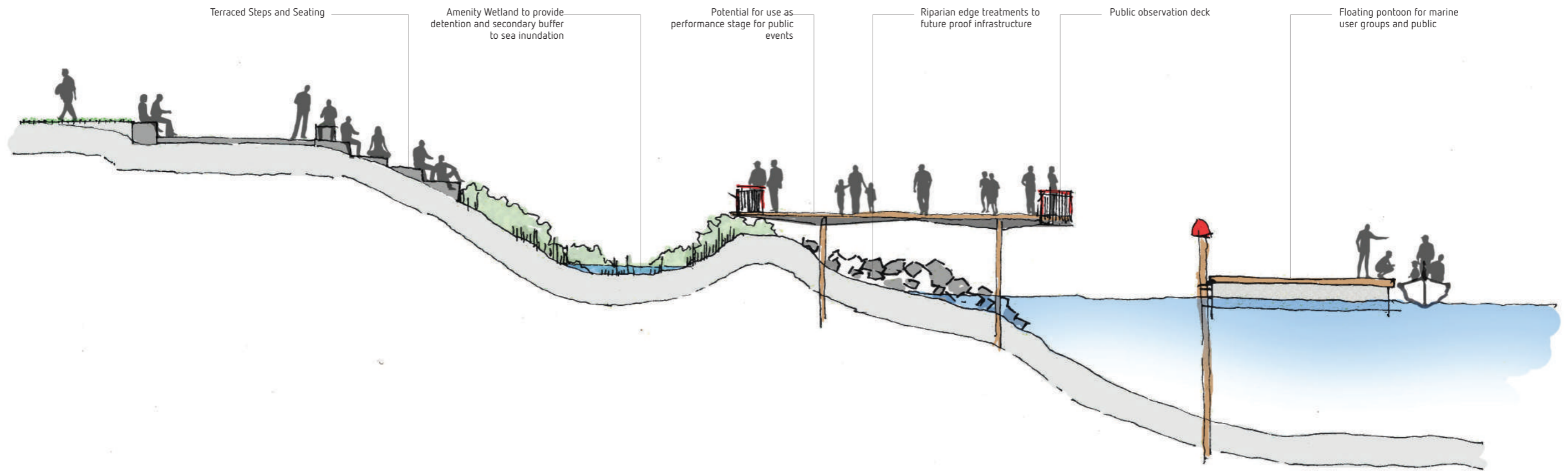

**SECTION ONE: SEATING TERRACES AND VIEWING DECK**  
NOT TO SCALE

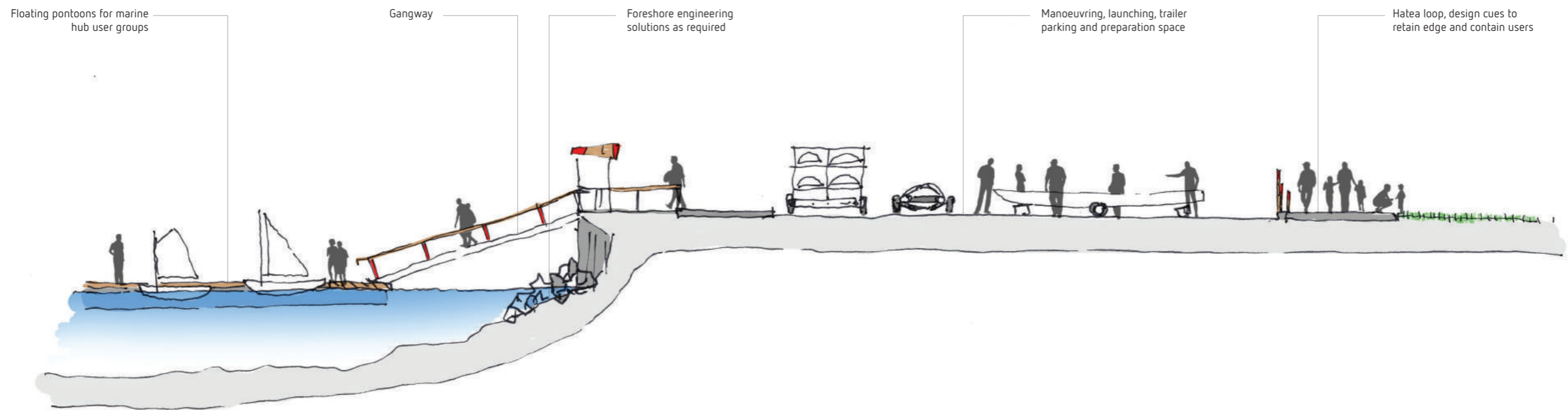

**SECTION TWO: MARINE LAUNCHING AND HATEA LOOP**  
NOT TO SCALE



# MARINE ZONE - LOOK AND FEEL



Observation Deck



Concrete Terrace Steps



Outdoor Space by Water



Coastal Riparian Planting



Pontoon Access to Water



Richmond Rowing Club, Australia



Sir Don Rowland Rowing Centre, Karapiro



Wharewaka, Wellington



Nga Hau Maiangi, Auckland

# HATEA HUB - MASTERPLAN

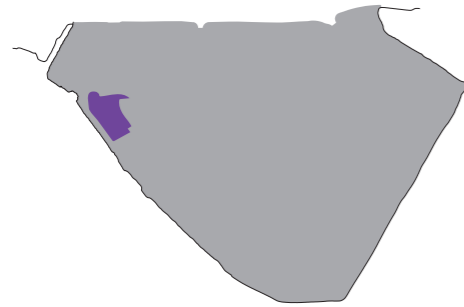

## Legend

- 1 Observation deck overlooking Hatea River and pontoons with potential use as events stage with outlook back to terraced bank
- 2 Concrete terraced bank with seating opportunities
- 3 Community Pavilion / Concessions
- 4 Toilet and change facilities
- 5 Multipurpose Events Lawn connecting to Marine Hub building for services, amenities and potential activation for a variety of community events
- 6 Entrance to Events Lawn offers arrival experience and connects to new car park for event users
- 7 Picnic and Informal Recreation Lawns
- 8 Waterplay with 'source to sea' narrative featuring kinetic and automated waterplay
- 9 Destination Playspace providing all abilities play experience - featuring signature play elements, nature play and multi generational inclusion
- 10 Youth and multigeneration active zone - exercise, basketball, table tennis, multisports surfaces
- 11 Community hub - Shelters, Barbeques, Group Dining Tables and Seating
- 12 Amenity Wetland and Stormwater Detention prior to discharge to Hatea river
- 13 Vegetated treatment swale
- 14 Mountain bike trail ends - bike racks and maintenance station
- 15 Existing Football Fields
- 16 New car park
- 17 Pohe Island Birthmark - Original Island Footprint and Cultural Interpretation
- 18 Nature play edge
- 19 Original Pohe Island Footprint

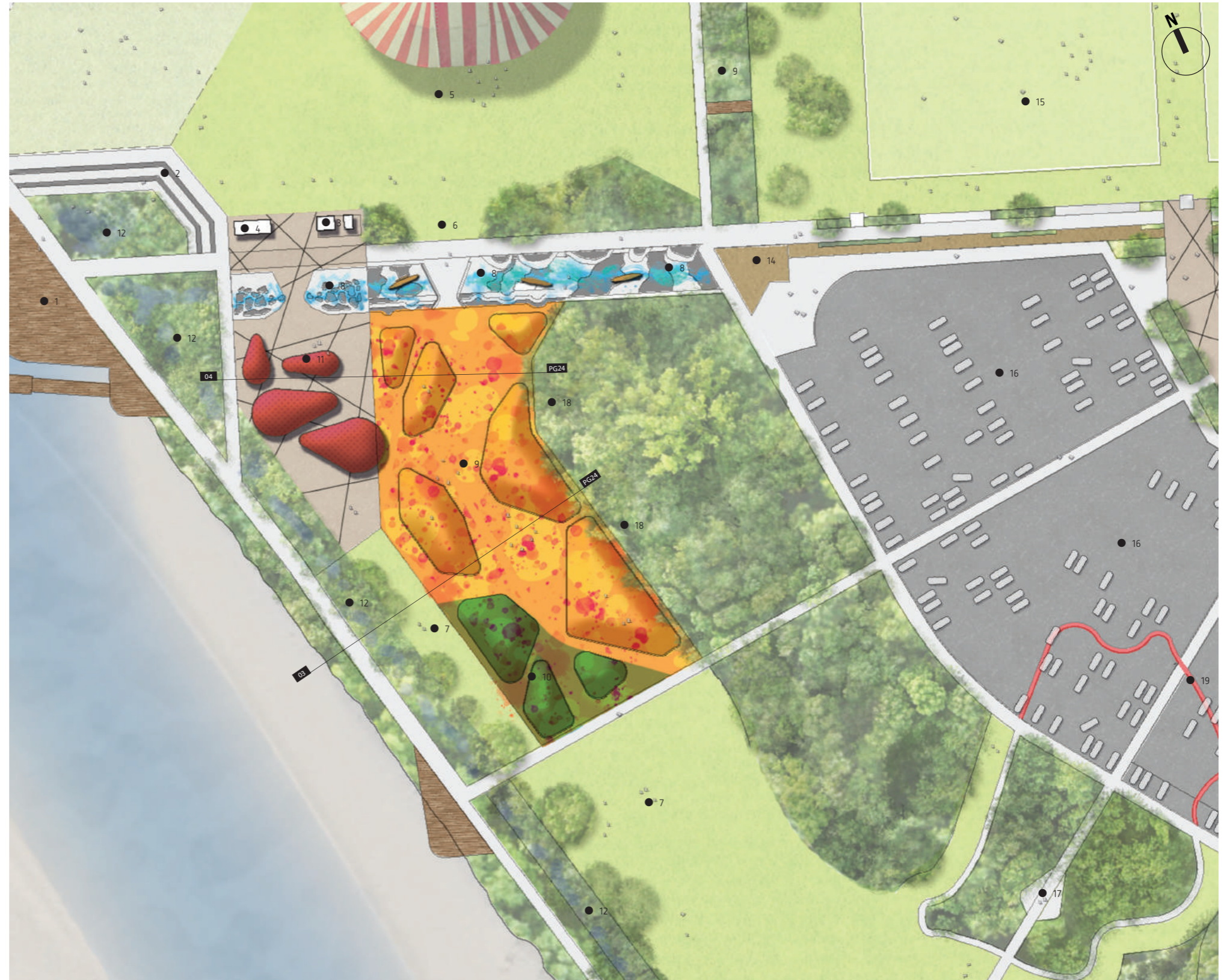

1:1000 (A3) 0 5 10 15 20 25 30 35 40 45 50 m

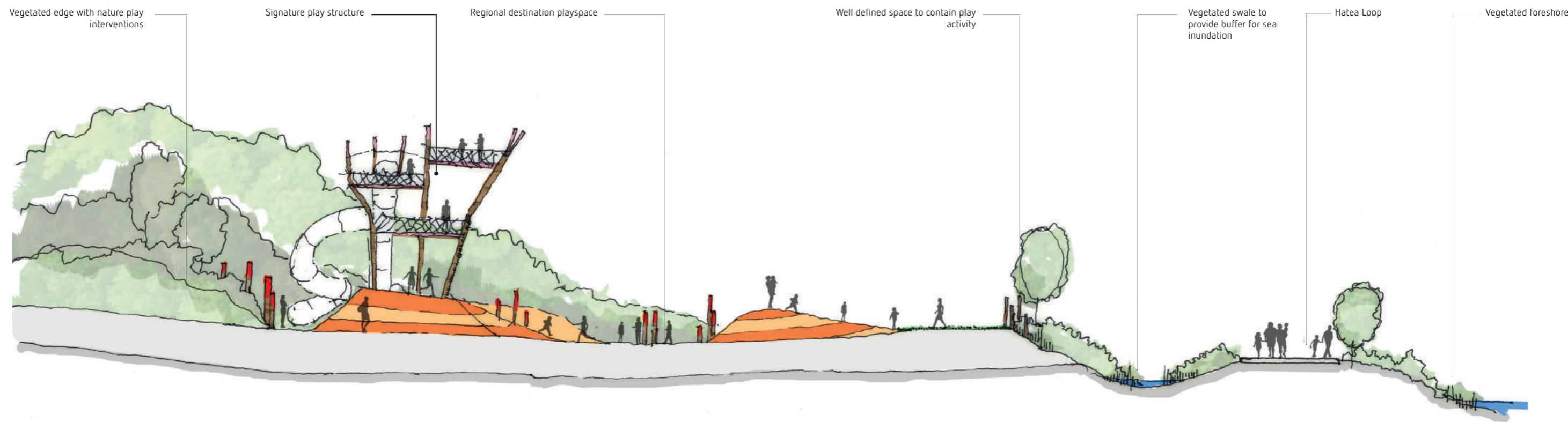

**SECTION THREE: PLAYSPACE WITH SIGNATURE STRUCTURE**  
NOT TO SCALE



**SECTION FOUR: PLAYSPACE WITH COMMUNITY HUB**  
NOT TO SCALE

Sections not to scale

# HATEA HUB - LOOK AND FEEL



Water Play - Kinetic



Water Play - Jets/Auto



Tower Play



Nature Play



Youth Play



Exercise Play



Avalon Park, Lower Hutt - By WSP Opus



Margaret Mahy Playground, Christchurch - By WSP Opus



Avalon Park, Lower Hutt - By WSP Opus



Margaret Mahy Playground, Christchurch - By WSP Opus

# BIKE HUB - MASTERPLAN

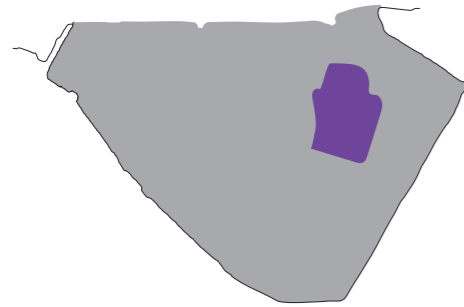

## Legend

- 1 Existing rugby fields
- 2 Vehicle access to bike facilities
- 3 Restricted vehicle access for events and overflow parking
- 4 Amenity wetland and stormwater detention
- 5 Existing toilet block
- 6 Learn to Ride and Road Skills facility. Providing diverse offerings with formal learning with road intersections and skills tests and also play based learning for balance bikes and young users
- 7 Learn to ride, level two
- 8 Repurposed recycling building for Bike Northland
- 9 Pathway network to provide for Criterium Track with specific design to enable closure of track for criterium events while maintaining public access with informal pathway adjacent
- 10 Community Pump Track Facility
- 11 Multimodal pedestrian and cycle bridge with arts and culture input to create iconic structure
- 12 New car park
- 13 Roundabout to control intersection
- 14 Plaza space to intersect site axis and provide string of public spaces through the bike hub
- 15 BMX Track
- 16 BMX track staging and event area
- 17 Dog Park



1:1000 (A3) 0 5 10 15 20 25 30 35 40 45 50 m



Additional packed earth track to allow public thoroughfare when criterium track is in use and to connect to mountain bike skills area

Pavement to be used as criterium track. Surface markings and marker posts to show distances and multiuse

**SECTION FIVE: RECYCLE HUB**  
NOT TO SCALE

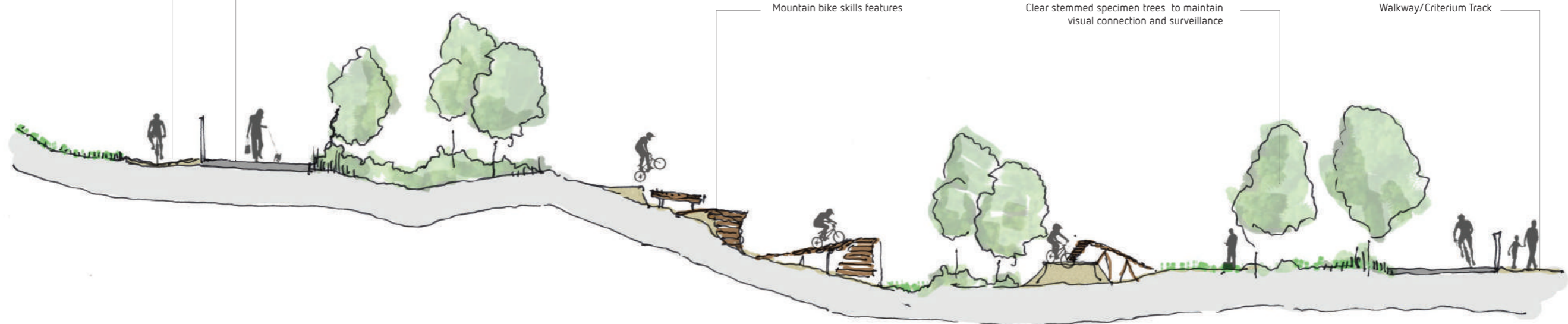

**SECTION SIX: MOUNTAIN BIKE SKILLS AREA**  
NOT TO SCALE

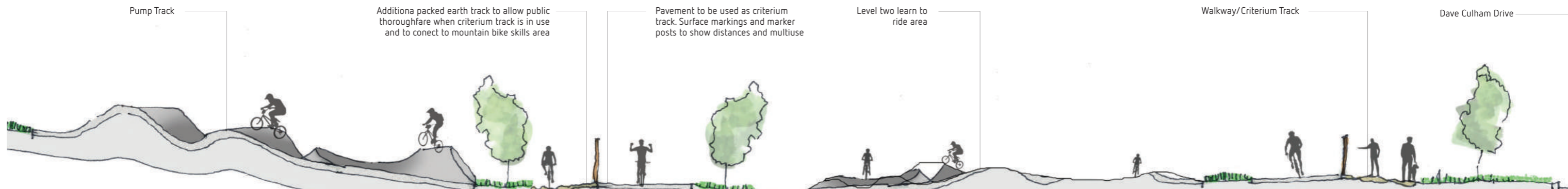

**SECTION SEVEN: WALKWAY/ CRITERIUM AND PUMP TRACK**  
NOT TO SCALE

Sections not to scale

# BIKE HUB - LOOK AND FEEL



Pump Track



Skateable Street Furniture



Bike Path



Learn to Ride



Landfill Park



Tensile Canopy



Sydney Park Cycling Centre, Australia



Ryde Bike and Scooter Track, Australia



Sydney Park Cycling Centre, Australia



Porirua Kiosk, Porirua

# KEY MOVES - MASTERPLAN

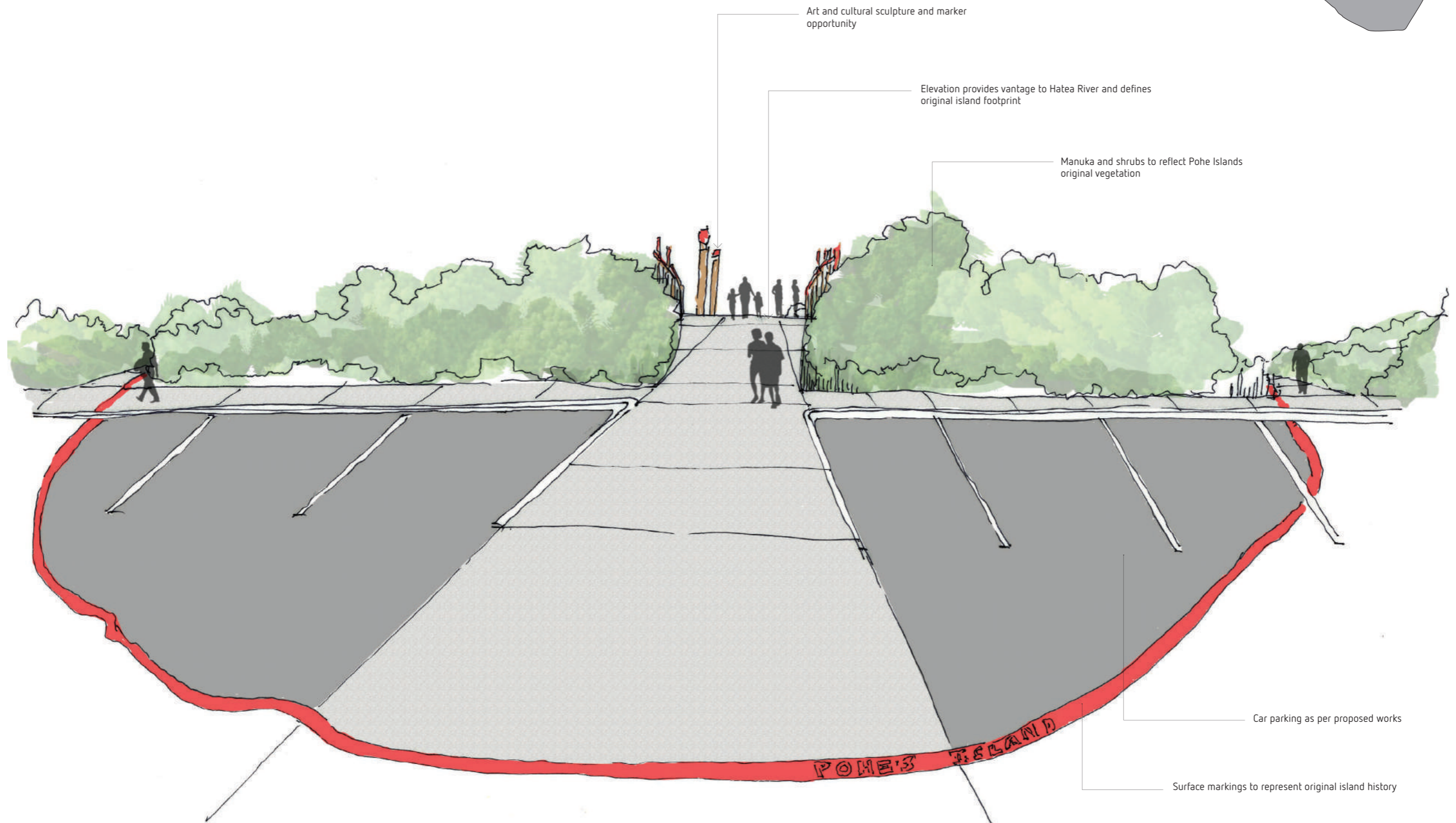
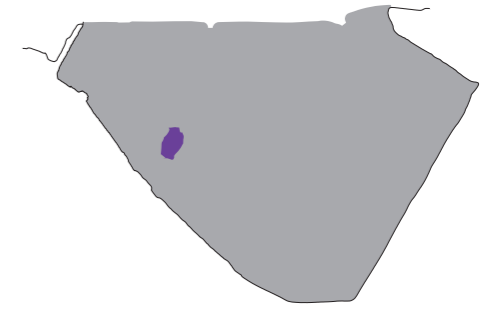

**POHE ISLAND BIRTHMARK: REPRESENTING THE HISTORY OF THE SITE**

Not to scale



# KEY MOVES - MASTERPLAN

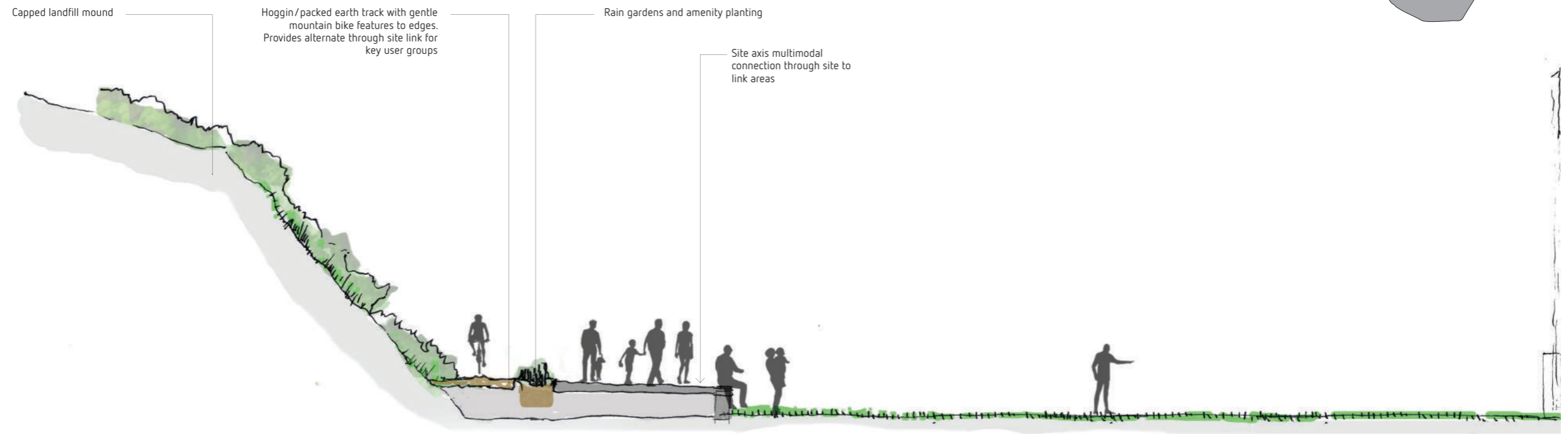
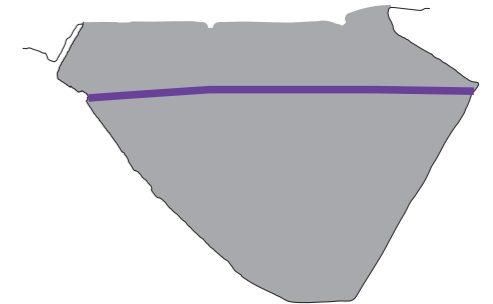

**SECTION EIGHT: SITE AXIS - TYPICAL NARROW CONDITION**  
NOT TO SCALE

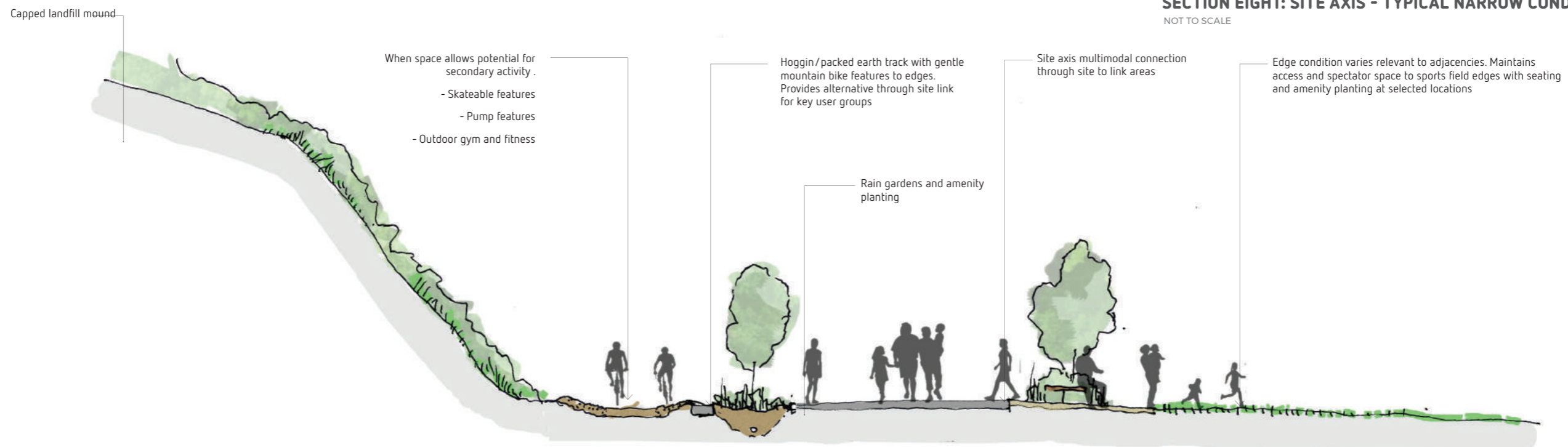

**SECTION NINE: SITE AXIS - TYPICAL WIDE CONDITION**  
NOT TO SCALE

Sections not to scale

# INDUSTRY BENCHMARK PROJECTS



Fresh Kills, New York City



Hunter's Point South Waterfront Park, New York City



Hunter's Point South Waterfront Park, New York City



Green Hills County Park, North Carolina, USA



Sculpture by the Sea, Bondi, Australia



Green Hills County Park, North Carolina, USA



Puente Hills, Los Angeles, USA



Margaret Mahy Family Park, Christchurch



Byxbee Park, California



Sydney Park Cycle Centre, Australia

# SITE MATERIALS PALETTE



Timber



No-fines permeable concrete

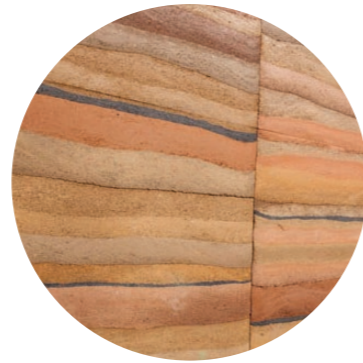

Rammed Earth



Gabion Mesh Baskets



Hoggin (Compacted Aggregate + Lime)

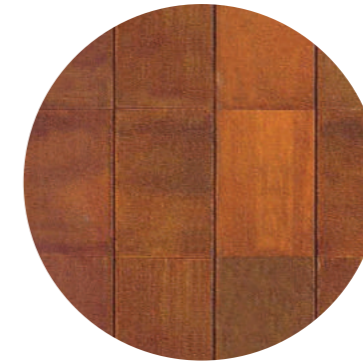

Corten Steel



Timber Cladding



Timber Clad Furniture



Sandblast Exposed Aggregate



Pavement Treatments



# PLANTING PALETTE KEY SPECIES



*Leptospermum scoparium*  
Mānuka



*Cordyline australis*  
Cabbage Tree



*Cyathea medullaris*  
Mamaku



*Geniostoma ligustrifolium*  
Hangehange



*Kunzea linearis*  
Kānuka



*Juncus pallidus*  
Wiwi



*Austroderia toetoe*  
NZ Toetoe



*Cyperus ustulatus*  
Giant Umbrella Sedge



*Coprosma robusta*  
Karamu



*Melicytus ramiflorus*  
Mahoe



*Myrsine australis*  
Mapau



*Vitex lucens*  
Pūriri



*Weinmannia silvicola*  
Tōwai or Tawhero



*Samolus repens*  
Maakoako



*Syzygium maire*  
Swamp Maire



*Meryta sinclairi*  
Puka



*Carex virgata*  
Swamp Sedge



*Apodasmia similis*  
Oioi



*Carex secta*  
Pukio



*Phormium tenax*  
Harakeke



*Pittosporum crassifolium*  
Karo



*Selliera radicans*  
Remuremu



*Juncus maritimus*  
Sea Rush



*Euphorbia glauca*  
Waiūartua